



# 128

## RECEIVER HITCH

### 2006 & Up DODGE PICKUP

INSTALLATION INSTRUCTIONS

1. Check all parts. Read and understand instructions completely before beginning installation.

- |                                  |  |                                    |
|----------------------------------|--|------------------------------------|
| 1) Receiver Hitch Center Section | 2) 5/8" x 4" All Thread Carriage Bolts | 6) 5/8" Plated Nuts                |
| 1) Left Hanger                   | 6) 14x40mm Hex Bolts                   | 6) 5/8" Plated Lockwashers         |
| 1) Right Hanger                  | 6) 14mm Nuts                           | 4) 5/8" x 2" Plated Carriage Bolts |
| 2) Curved Spacers 5/8" Slot      | 6) 14mm Lockwashers                    | 4) Flat 5/8" Slot Spacers          |

2. **Fish-Wire.** A 5/8" x 2" Carriage bolt and Slot Spacer must be placed in the forward large holes on each side. Slide or Fish-Wire the Slot Spacers, long portion of the slot facing forwards, through the end of the frame, under the bumper bolts and to this large hole. There are two ways to get the carriage bolt up and through the slot.

1. Hook the Fish-Wire up through the large hole, through the Spacer and down and out of the frame, tie the threaded end of the Bolt and pull the Bolt up into the frame and down through the Spacer.

Or 2. On the side of the frame forward of the hole is a large slot. Run your Fish-Wire through the Slot Spacer and forward and out of this large slot. Place the Carriage Bolt head first into this hole and tie your Fish-Wire to the threaded end and pull back through the Slot Spacer.

**Important!** Leave the Fish-Wire attached in case the Bolt is pushed back into the frame.

3. **Place** into the round tube crossmember, first a Curved Washer, then a long Carriage Bolt down at an angle through the frame (see illustration below).

4. **Raise a Hitch Hanger** into place with the mounting flange pointing towards the outside of the vehicle. Match the holes with the 5/8" bolts in the frame. Secure with a Lockwasher and Nut on each bolt. Hand tighten.

5. **Place** a 5/8" Carriage Bolt through the bumper bracket slot and the round hole in the Hitch Hanger. Use the 1/4" Spacer between the two if there is too big of a gap. Secure with a Lockwasher and Nut. Hand tighten.

6. **Raise Center Section** into place. For the **1500 models**, the long portion of the mounting flanges point up. For the **2500 models**, the flanges point down. Secure each Center Section hole with a 14mm Hex Bolt, Lockwasher and Nut. Hand tighten.

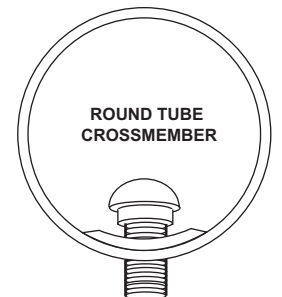

7. **Tighten all mounting Bolts.** 14mm Bolts to 100 ft/lbs. 5/8" Bolts to 150 ft/lbs. Use a torque wrench.  
**CAUTION: Do not overtighten rear carriage Bolts.**

<b>GROSS LOAD</b>		
HITCH TYPE	MAX TRLR WT (LB)	MAX TONGUE WT (LB)
WEIGHT DISTRIBUTION	<b>10,000</b>	<b>1,000</b>
WEIGHT CARRYING	<b>5,000</b>	<b>500</b>

DO NOT EXCEED VEHICLE'S  
MANUFACTURER'S RECOMMENDED TOWING CAPACITY

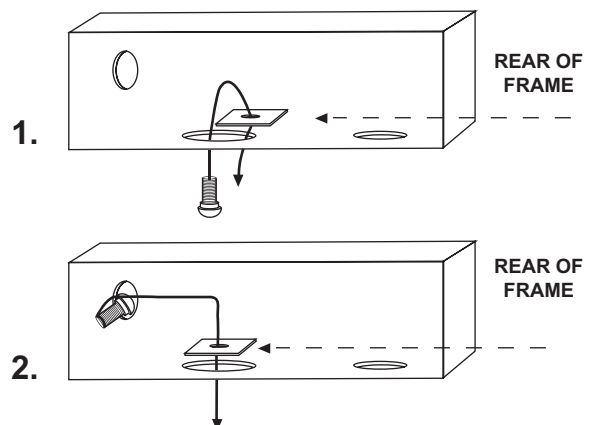

The manufacturer warrants this product to be free of defects in material or workmanship at the time of retail purchase by the original purchaser. If the product is found to be defective, the manufacturer may repair or replace the product, at its option, when product is returned, prepaid, with proof of purchase to the manufacturer. Alteration to, misuse of, or improper installation of product voids this warranty. Manufacturer's liability is limited to repair or replacement of products found to be defective, and specifically excludes liability for incidental or consequential loss or damage.

Quality S Manufacturing, Inc., Phoenix, AZ